

MALTA TOWNSHIP SECTION 16 R-12 TWP-10 MORGAN COUNTY, OH

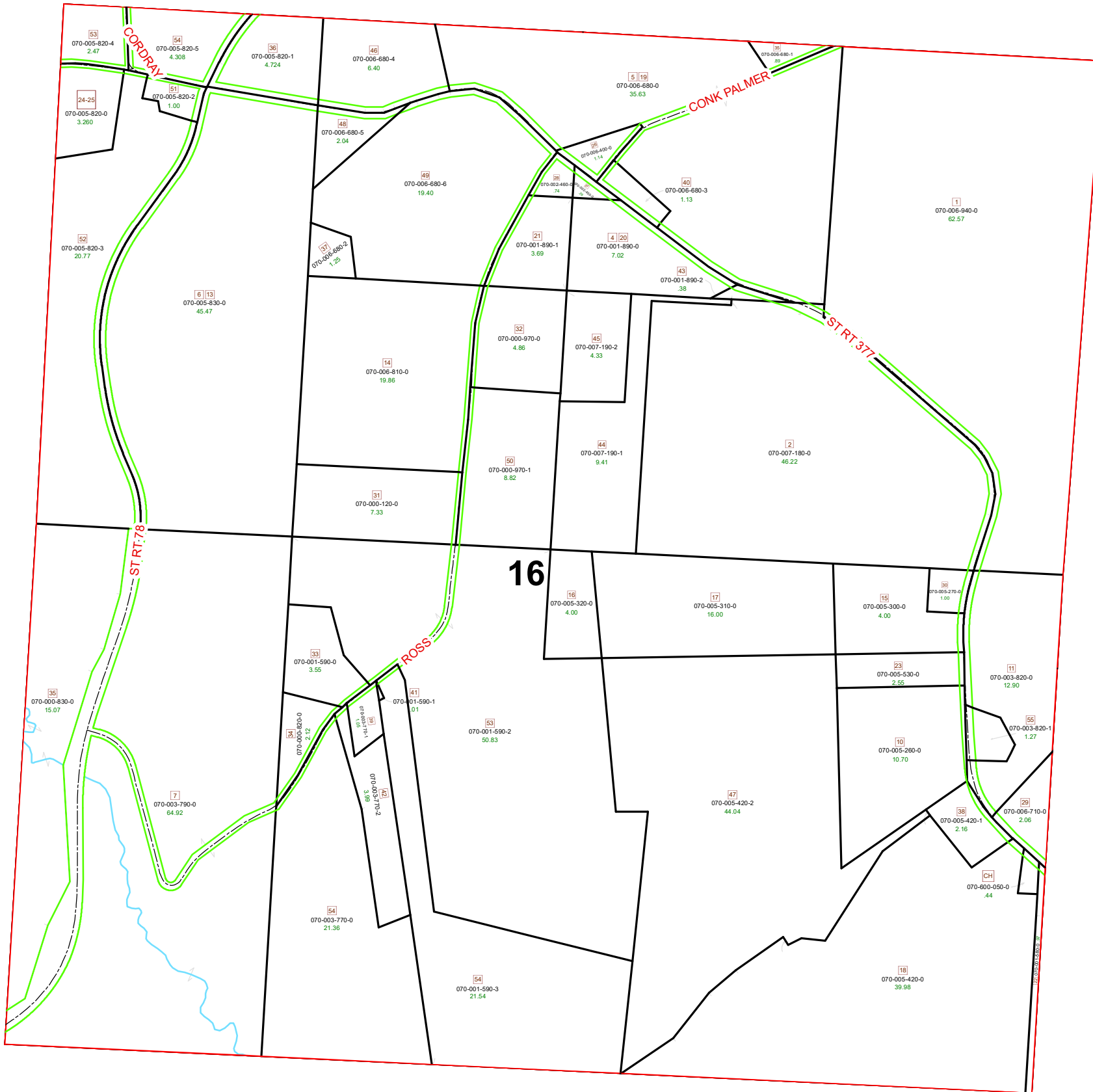

PIN	VOL	PAG	Owner	LegalDescr	Acres
070-005-260-0	OR232	2815	BOLE TREVOR & ABBY SEBRING	R12 T10 S16 SD 10	10.708
070-003-820-1	OR226	2336	BRITTANY M FINLEY	R12 T10 S16 SD 55	1.27
070-000-830-0	D.V 182	507	CAMPBELL CECIL L & TERRI L	R12 T10 S16 SD 35 SU	15.079
070-600-050-0	D.V 97	436	CHURCH (FIRST BAPTIST)	R12 T10 S16 0	0.44
070-005-420-1	OR218	1674	CLAWSON CALEB E	R12 T10 S16 SD 38	2.166
070-005-420-2	OR218	1674	CLAWSON CALEB E	R12 T10 S16 SD 47	44.04
070-007-180-0	OR229	3123	CLAWSON GORDON E & ANGELA D	R12 T10 S16 SD 2 SUR	46.22
070-007-190-1	OR212	22	CLIFTON TODD A	R12 T10 S16 SD 44	9.41
070-007-190-2	OR103	365	CLIFTON TODD A	R12 T10 S16 SD 45	4.33
070-001-890-2	OR212	22	CLIFTON TODD A	R12 T10 S16 SD 43	0.38
070-001-580-0	OR219	488	DEARTH KRISTY & BERYL E DARBY	R12 T10 S16 SD 22 SU	0.977
070-006-710-0	OR229	2248	DEARTH KRISTY L	R12 T10 S16 SD 12-29	2.061
070-001-890-0	OR29	797	FISCHER DARYL & GENEVA	R12 T10 S16 SD 4-20-	7.025
070-000-120-0	OR201	244	GESSEL SUELLEN D & JOHN T	R12 T10 S16 SD 31 UN	7.33
070-002-450-0	D.V 193	55	GOINS EVELYN S	R12 T10 S16 SD 27	0.26
070-002-460-0	D.V 193	55	GOINS EVELYN S	R12 T10 S16 SD 28	0.74
070-006-680-4	OR215	2990	GREJUY FAMILY TRUST ETAL	R12 T10 S16 SD 46	6.4
070-006-680-5	OR196	3	GREJUY JUSTIN ANDREW & TRACI LEIGH	R12 T10 S16 SD 48 SU	2.04
070-006-680-2	OR18	573	GREJUY MICHAEL DREW	R12 T10 S16 SD 37	1.253
070-000-970-1	OR216	2096	GREJUY MICHAEL DREW & TAMI	R12 T10 S16 SD 50 SU	8.818
070-006-680-6	OR197	789	GREJUY MICHAEL DREW & TAMI	R12 T10 S16 SD 49 SU	19.408
070-006-680-0	OR224	1013	GREJUY WILLIAM J & BARBARA J TRUSTEES	R12 T10 S16 SD 5-19	35.638
070-003-820-0	OR224	1013	GREJUY WILLIAM J & BARBARA J TRUSTEES	R12 T10 S16 SD 11	12.9
070-006-400-0	OR219	316	HANN JOHN M & AMANDA R LANE	R12 T10 S16 SD 26 SU	1.14
070-001-890-1	OR231	5180	KENNEDY DEBBIE MARIE	R12 T10 S16 SD 21	3.695
070-001-590-0	OR225	3301	KOLLER BETSY RAKA BETSY ROSS KOLLER	R12 T10 S16 SD 33	3.55
070-001-590-3	OR225	3301	KOLLER BETSY RAKA BETSY ROSS KOLLER	R12 T10 S16 SD 54	21.549
070-003-770-2	OR205	295	KOLLER ROSS P TRUSTEE	R12 T10 S16 SD 42	3.998
070-003-770-1	OR205	295	KOLLER ROSS P TRUSTEE	R12 T10 S16 SD 39	1.052
070-001-590-1	OR225	3294	KOLLER ROSS P TRUSTEE	R12 T10 S16 SD 41	0.019
070-005-820-1	OR230	2836	KYLE AND MELISSA DILLARD LIVING TRUST	R12 T10 S16 SD 36	4.724
070-006-940-0	OR70	212	LEEPER ROBERT STEPHEN	R12 T10 S16 SD 1	62.57
070-005-820-2	OR218	2317	MILLER ANTHONY JOHN	R12 T10 S16 SD 51	1.003
070-005-820-3	OR218	2317	MILLER ANTHONY JOHN	R12 T10 S16 SD 52	20.779
070-003-790-0	OR27	191	MILLER TITUS & FREIDA	R12 T10 S16 SD 7 SUR	64.921
070-003-770-0	OR27	191	MILLER TITUS & FREIDA	R12 T10 S16 SD 8 SUR	21.36
070-006-810-0	OR63	214	MOORE JAMES R & THERESA D	R12 T10 S16 SD 14 SU	19.86

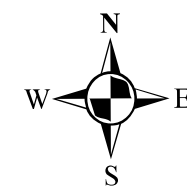

Boundaries	
-----	Hidden
-----	Roads
-----	County
-----	Parcel
-----	Parcels
-----	ROW
-----	Section
-----	Township
-----	Lot
-----	Hydro



Disclaimer: The information that these maps contains is for reference purposes only. Please bring any erros to the attention of the Engineer's Office staff.

Thank you

MALTA TOWNSHIP SECTION 16 R-12 TWP-10 MORGAN COUNTY, OH

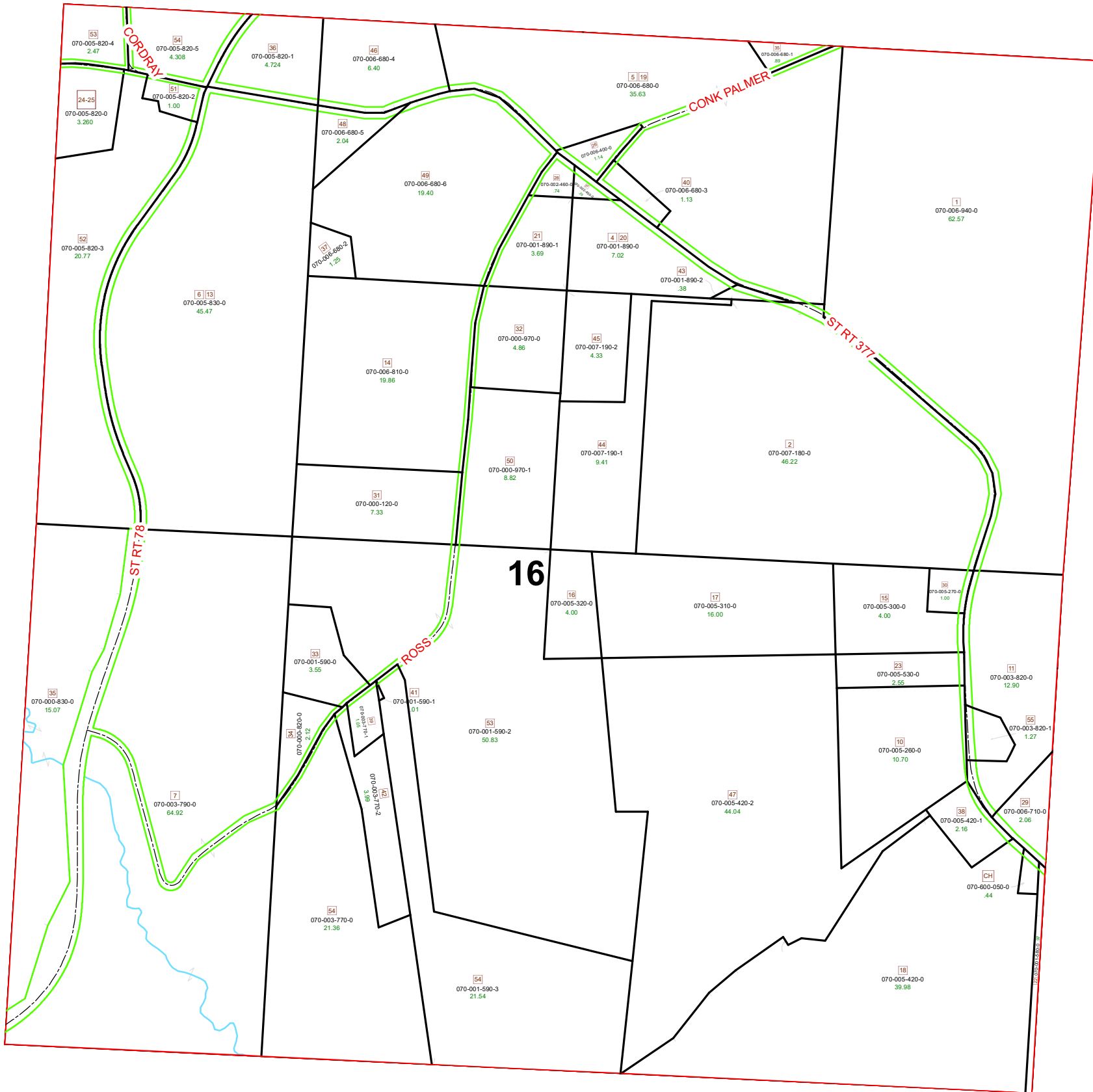

PIN	VOL	PAG	Owner	LegalDescr	Acres
070-005-420-0	OR202	802	NOLAND JAMES P & DEBRA L	R12 T10 S16 SD 18 SU	39.988
070-005-310-0	OR221	2246	NORMAN DAVID E	R12 T10 S16 SD 17	16
070-005-320-0	OR221	2246	NORMAN DAVID E	R12 T10 S16 SD 16	4
070-005-300-0	OR221	2246	NORMAN DAVID E	R12 T10 S16 SD 15	4
070-005-270-0	OR221	2246	NORMAN DAVID F & CLORIS A	R12 T10 S16 SD 30	1
070-005-530-0	OR171	542	PARKER MARY ET4AL	R12 T10 S16 SD 23	2.55
070-001-590-2	OR232	1065	RAINES JESS N & KELLY E	R12 T10 S16 SD 53	50.832
070-005-830-0	OR218	82	RAY DANNY L & WENDY J TOD-CHRISTOPHER RAY	R12 T10 S16 SD 6-13	45.477
070-006-680-1	OR74	55	SAVAGE SAMUEL R II & DEIDRA D	R12 T10 S16 SD 35	0.891
070-006-680-3	OR28	268	SMITH PAUL V & BARBARA A	R12 T10 S16 SD 40	1.13
070-000-970-0	OR202	961	TULLIS TERRY L	R12 T10 S16 SD 32	4.862
070-000-820-0	OR79	380	WINNER JENNIFER L & WAYNE J	R12 T10 S16 SD 34 SU	2.12
070-005-820-4	OR218	2496	YOUNG JOHN MICHAEL & JENNIFER MARIE	R12 T10 S16 SD 53	2.474
070-005-820-5	OR218	2496	YOUNG JOHN MICHAEL & JENNIFER MARIE	R12 T10 S16 SD 54 SU	4.308
070-005-820-0	OR218	2496	YOUNG JOHN MICHAEL & JENNIFER MARIE	R12 T10 S16 SD 24-25	3.26

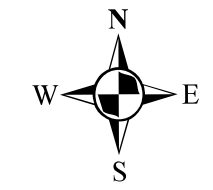

Boundaries	
----- Hidden	--- ROW
--- Hydro	--- Section
--- Roads	--- Lot
--- County	--- Parcel
----- Township	--- Parcels

